



NEW RANGE

GENERAL CHARACTERISTICS

- Equivalent Power** 18, 24 W
- Power supply** 180-265 VAC - 50/60 Hz
- Standard** EN60598-1, EN60598-2-1
- Protection grade** IP44
- Working temp.** -20°C ÷ +40°C
- Mounting** ceiling, wall
- Frame colour** white
- Housing** Self-extinguishing UV stabilized polycarbonate
- Diffuser** Self-extinguishing UV stabilized polycarbonate, opal
- Driver** Integrated, electronic

Full moon

Wall and ceiling LED luminaire

Ceiling luminaire suitable for ceiling or wall installation where strong and diffused lighting is required. The SENSOR and ANTI BLACK-OUT versions have been designed specifically for the lighting of stairs, interior corridors in shops, malls, hotels and restaurants. The SENSOR version is equipped with a microwave sensor capable of detecting the passage of people and automatically turning on. The ANTI BLACK-OUT version integrates an inverter and a battery to ensure 1h lighting autonomy in the event of a blackout.

The luminaire is equipped with high-efficiency LEDs whose positioning on the reflector has been designed to obtain a wide beam with high luminous efficiency.

ANTI BLACK-OUT

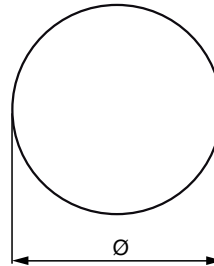

W	• Dimensions (mm) •		Weight kg
	Ø	H	
18	330	80	-
24	380	90	-

Full moon

W	Order Code	Description	EAN	Power W	Colour Temp.	Colour rendering index	Flux of LEDs (lm)	Flux of fixture (lm)	Luminous Efficiency (lm/W)	Energy Efficiency Class	Package single/multi
18	75330	FULLMOON 18W 3K	8002219866530	18	3000K	>80	1700	1440	80	A++	1/5
24	75332	FULLMOON 24W 3K	8002219866578	24	3000K	>80	2300	1920	80	A++	1/5
18	75331	FULLMOON 18W 4K	8002219866554	18	4000K	>80	1700	1440	80	A++	1/5
24	75333	FULLMOON 24W 4K	8002219866592	24	4000K	>80	2300	1920	80	A++	1/5

Full moon sensor with twilight and presence sensor

W	Order Code	Description	EAN	Power W	Colour Temp.	Colour rendering index	Flux of LEDs (lm)	Flux of fixture (lm)	Luminous Efficiency (lm/W)	Energy Efficiency Class	Package single/multi
18	75334	FULLMOON SENSOR 18W 3K	8002219866615	18	3000K	>80	1700	1440	80	A++	1/5
24	75336	FULLMOON SENSOR 24W 3K	8002219866653	24	3000K	>80	2300	1920	80	A++	1/5
18	75335	FULLMOON SENSOR 18W 4K	8002219866639	18	4000K	>80	1700	1440	80	A++	1/5
24	75337	FULLMOON SENSOR 24W 4K	8002219866677	24	4000K	>80	2300	1920	80	A++	1/5

Version with sensor – microwave motion sensor

Full moon anti black-out

W	Order Code	Description	EAN	Power W	Colour Temp.	Colour rendering index	Flux of LEDs (lm)	Flux of fixture (lm)	Luminous Efficiency (lm/W)	Energy Efficiency Class	Package single/multi
18	75338	FULLMOON ANTI BLACK-OUT 18W 3K	8002219866691	18	3000K	>80	1700	1440	80	A++	1/5
24	75344	FULLMOON ANTI BLACK-OUT 24W 3K	8002219866738	24	3000K	>80	2300	1920	80	A++	1/5
18	75339	FULLMOON ANTI BLACK-OUT 18W 4K	8002219866714	18	4000K	>80	1700	1440	80	A++	1/5
24	75345	FULLMOON ANTI BLACK-OUT 24W 4K	8002219866752	24	4000K	>80	2300	1920	80	A++	1/5

