

Instruction manual

Arietis LED SD IP65 recessed mounting

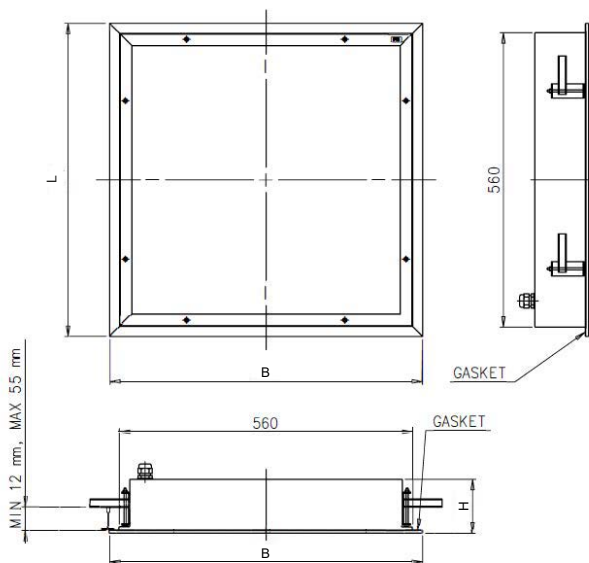

BEGHELLI - ELPLAST, a.s.
Elišky Junkové 768/6
642 00 Brno
Czech Republic
Tel.: +420 531 014 111
Fax: +420 531 014 210
beghelli@beghelli.cz



Code	Power	Lamp	L x B x H (mm)	Module	Hole cut out (mm)	Kg
A36-10150CWSD	42 W	LED	595x595x102	M600	565x565	4,5
A36-10150CMSD	42 W	LED	595x595x102	M600	565x565	4,5
A36-10150CWSD/AP	42W	LED	595x595x102	M600	565x565	4,5

- M - opal diffuser
- W - microprismatic diffuser
- AP - seal around the luminaire perimeter (gasket)

MOUNTING PROCEDURE:

Universal mounting into ceiling modules M600 and plaster ceilings (holders are supplied with the luminaire).

- Remove the diffuser by loosening the screws on the frame
- Installation of lighting fixture to the ceiling with four ceiling brackets that are set by the thickness of the ceiling with screws in the rim of the fixture.
- Installation of cable gland PG 13.5 for cable diameter 6-12mm to the bottom of the fixture.
- Connecting the lead wires to the terminals.
- SD driver can be connected with Radio Module (cod. 15022), Dali Module (cod. 15024), 1-10V Module (cod. 15034). Radio Module (cod. 15022). Stickers with code of the SD driver to be fitted to SD driver cover. Stickers with Radio module code to be fitted to the outer luminaire cover and into the technical drawing of the building luminaire plan. Dali Module (cod. 15024), 1-10V Module (cod. 15034) to be screwed with screws in front of SD driver (screws are part of the packaging).
- Assembly the diffuser and tighten each screw with tightening torque 0.6 Nm.

TECHNICAL DETAILS:

Rated voltage: 230V, 50Hz
Lamp: LED
Degree of protection: IP 65
Electrical accident protection class: I
Suitable for direct mounting onto a normally inflammable basis - F: yes
The luminaire satisfies requirements of all standards in force.
The lighting fixture allows inlay and below mounting
The minimum thickness for the below ceiling mounting is 12 mm, maximum is 55 mm
Microporous EPDM seal around the circumference of the luminaire

WARNING:

- Check whether the mains specification satisfies the data mentioned on a luminaire plate before connecting it to the mains.
- Contact the customer service authorised centre for repairs, and insist on using original spare parts only. Not satisfying these instructions could result in loss of luminaire safety or in loss of warranty.
- This luminaire should only be used for a purpose for which it was manufactured. Any other usage shall be assumed to be unsuitable and therefore dangerous. The manufacturer bears no responsibility for any injury caused to persons or animals or for property damages caused by improper, faulty or inadequate usage.
- A luminaire must be disconnected from the mains before any interference with a luminaire, service or maintenance. An expert person, in terms of valid regulations concerning the competence to activities, should only perform these actions.
- The luminaire may only be connected to the mains, whose installation and protection satisfies standards in force.

WARRANTY:

All products of the company Beghelli - Elplast, a.s. are made of the highest quality materials, thoroughly tested and guaranteed by the manufacturer to be free of defects in terms of existing legislative regulations. This warranty becomes invalid if mounting is not executed according to the instruction manual, the luminaire is damaged or modified or repaired by an unauthorised service centre of the company Beghelli - Elplast, a.s.
The product cannot be disposed as unsorted municipal waste. It must be collected separately to prevent negative environmental impacts. In accordance with the procedures of Directive 2002/96 and relevant national laws and regulations adopted pursuant to this Directive on the disposal of waste at the end of the life cycle of the product, any violation is sanctioned by law. Please inform yourself about the local separate collection system for electrical and electronic products.

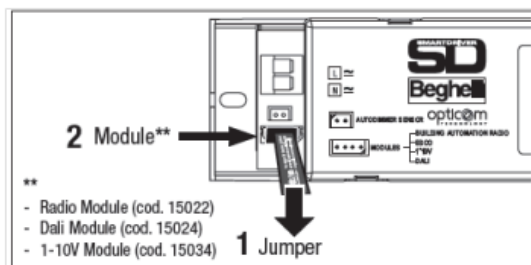

- ** - Radio Module (cod. 15022)
- Dali Module (cod. 15024)
- 1-10V Module (cod. 15034)

